

EL 1010.00

EL 1010.00

EL 1010.00

PROFILE
Scale: 1" = 10'
Vertical: 1" = 5'

BENCH MARK
Scribble SE 13th & St. EL 1010.00 M.S.L.
Scribble SW 13th & St. EL 1010.00 M.S.L.

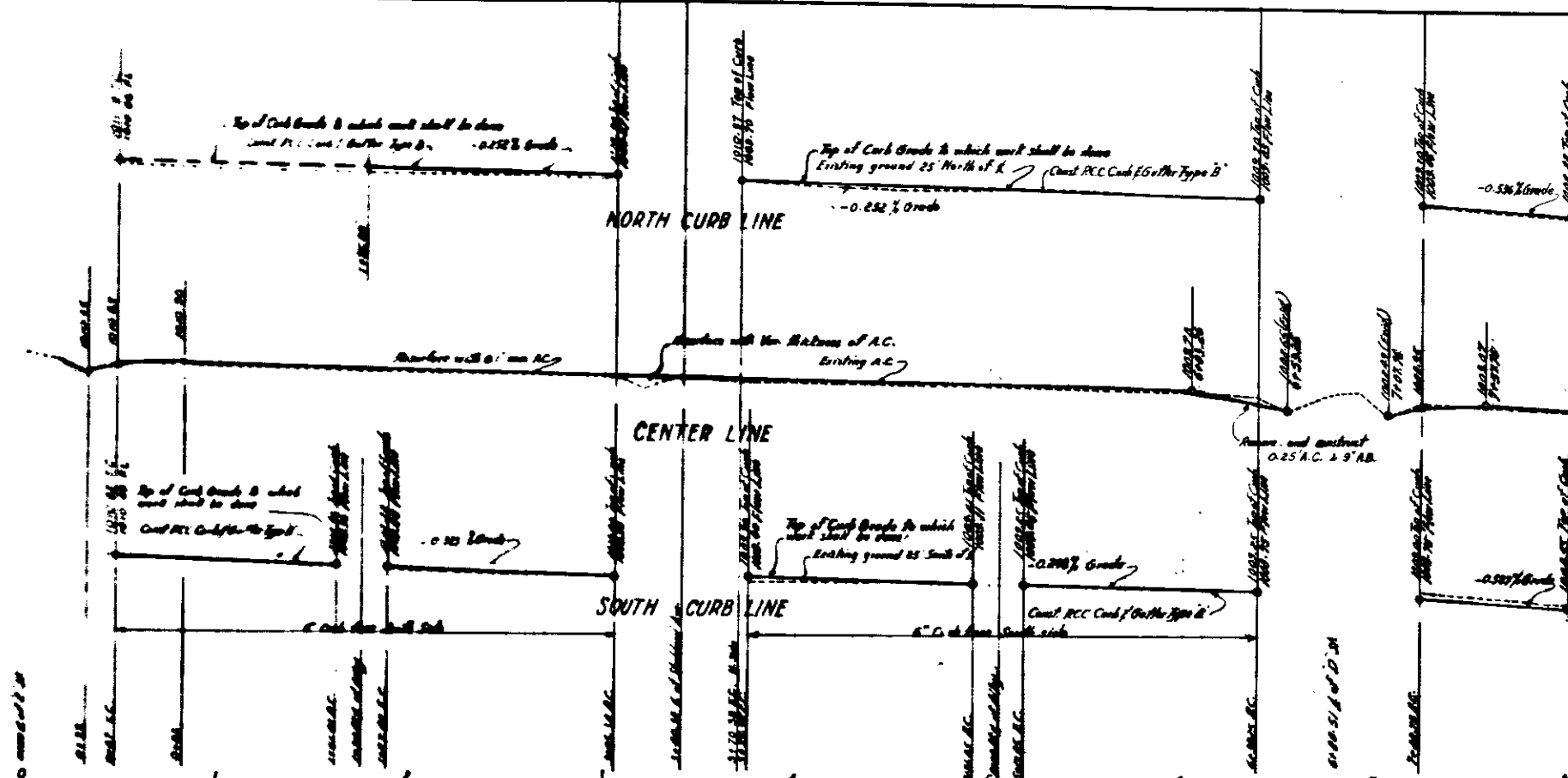

- GENERAL NOTES**
- All work indicated on this plan shall be done conformably with applicable provisions of Spec. No. 6271 and Standard Drawings No. 2321 as the Office of the City Engineer.
 - Access Curb for Driveways where necessary. Locations and widths to be determined on the profiles and to exceed City Standards.
 - Adjust all sewer Appurtenances to grade of the completion of paving.
 - Payment for all removals, construction and work shall be included in prices paid for other conditions of work and no additional compensation will be allowed therefor.
 - Removal of Obstructions (marking on plan) directed by Engineer.
 - To be removed and relocated under the Center Line (marking on Street signs shall be Class B' unless as original installation).
 - To be removed and relocated by others.
 - To be removed under this contract.
 - To be removed and deposited on adjacent property.

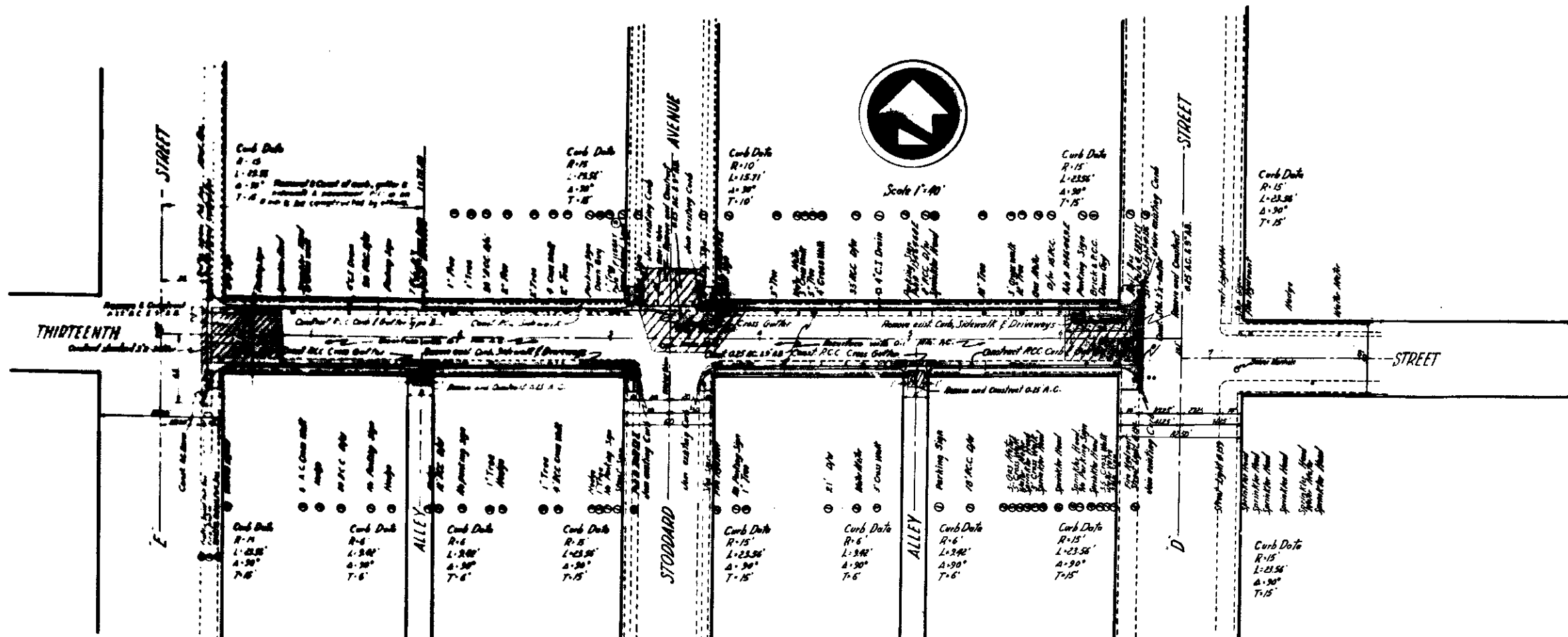

APPROVED: September 10, 1968
 CITY ENGINEER
 REGISTERED CIVIL ENGINEER NO. 12652
 DEPARTMENT OF ENGINEERING
 CITY OF SAN BERNARDINO
 DRAWING NO. 2870
 DRAWN BY: M. L. Dean
 THIRTEENTH STREET

EL 1010.00

EL 1010.00

EL 1010.00

PROFILE
Scale: 1" = 10'
1" = 10'

BENCH MARK
Scribble SE 13th & St. EL 1010.00 M.S.L.
Scribble SW 13th & St. EL 1010.00 M.S.L.

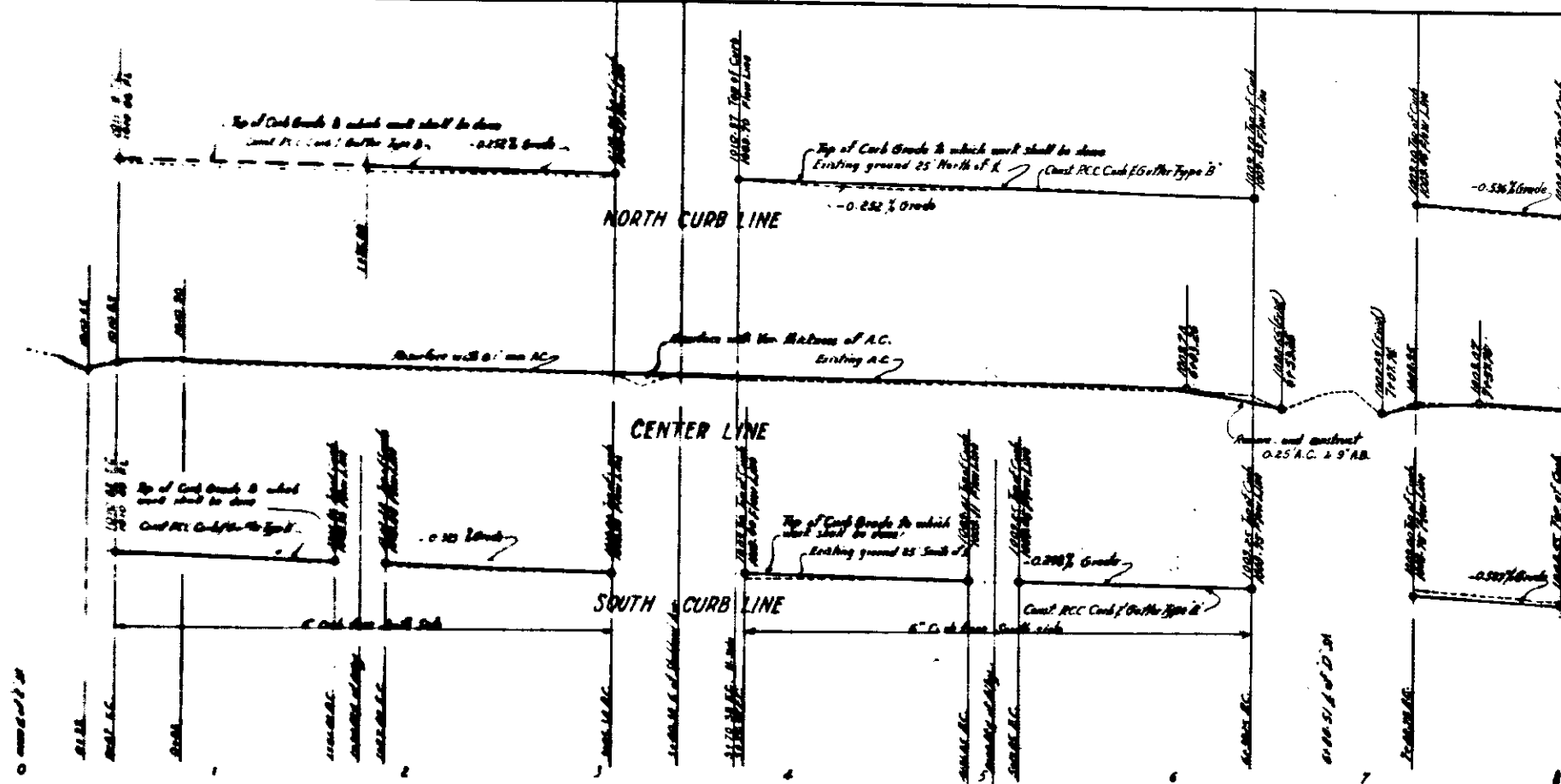

- GENERAL NOTES**
- All work indicated on this plan shall be done conformably with applicable provisions of Spec. No. 6271 and Standard Drawings No. 2321 as the Office of the City Engineer.
 - Access Curb for Driveways where necessary. Locations and width to be determined on the field and not to exceed City Standards.
 - Adjust all sewer Appurtenances to grade of the completion of paving.
 - Payment for all removals, construction and work shall be included in prices paid for other conditions of work and no additional compensation will be allowed therefor.
 - Removal of Obstructions (marking on plan) directed by Engineer.
 - To be removed and relocated under the Center Line (marking on Street signs shall be Class B' unless as original installation).
 - To be removed and relocated by others.
 - To be removed under this contract.
 - To be removed and deposited on adjacent property.

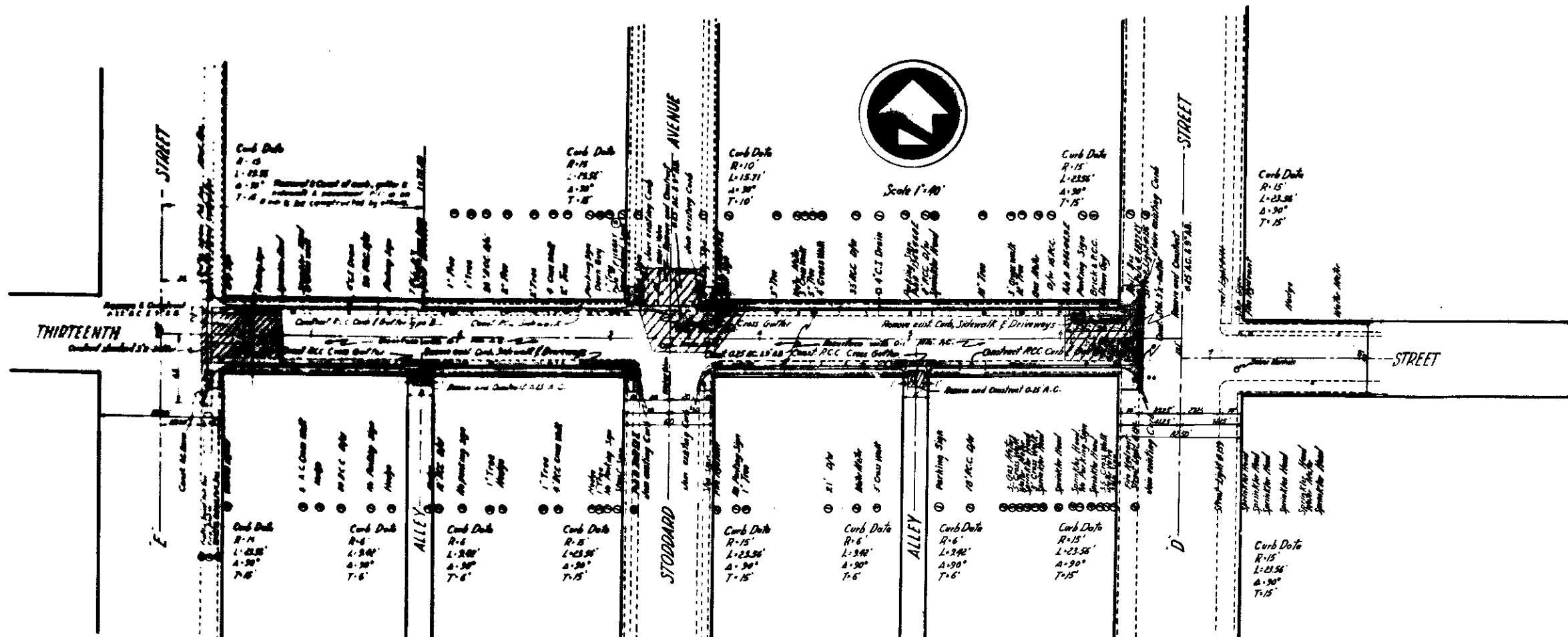

APPROVED: September 10, 1968
 CITY ENGINEER
 REGISTERED CIVIL ENGINEER NO. 12652
 DEPARTMENT OF ENGINEERING
 CITY OF SAN BERNARDINO
 DRAWING NO. 2870
 DRAWN BY: M. L. Dean
 THIRTEENTH STREET